

first floor & main entrance

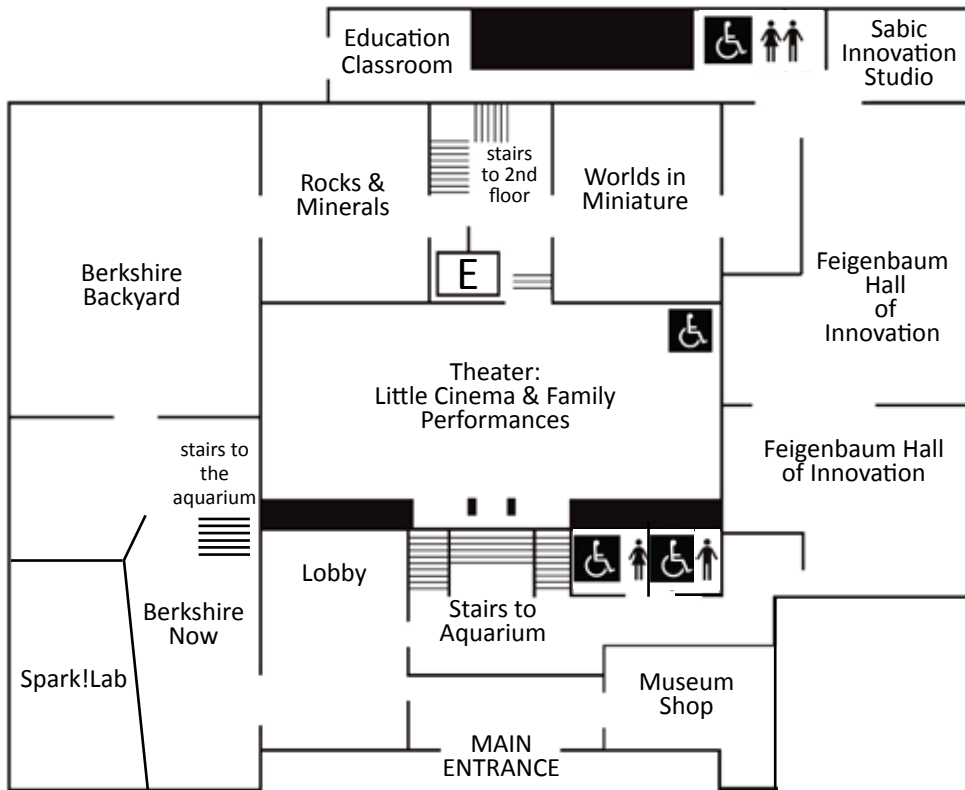

wheelchair accessible restroom



restrooms



elevator

E

Photography Policy

Non-flash photography of natural science and history collections is allowed. Non-flash photography of works of art or sculpture for personal use only is allowed.

Writing utensils or professional photography in the painting galleries is not permitted without prior consent.

Food and beverages are not permitted in the galleries.

Thank you for your cooperation.

*While visiting the Berkshire Museum today you may be photographed or filmed. The Museum may use this for promotional purposes including advertisements, brochures, websites, and other materials. If you have any questions or concerns about how your photograph is used, please email info@berkshireremuseum.org.

second floor

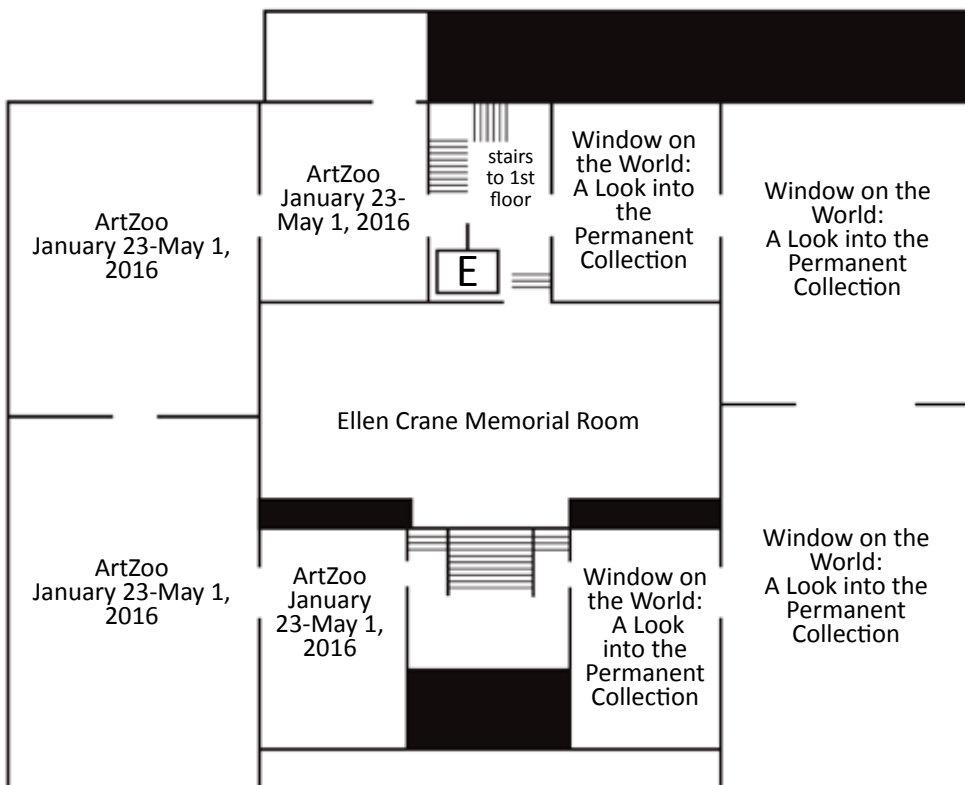

aquarium (lower level)

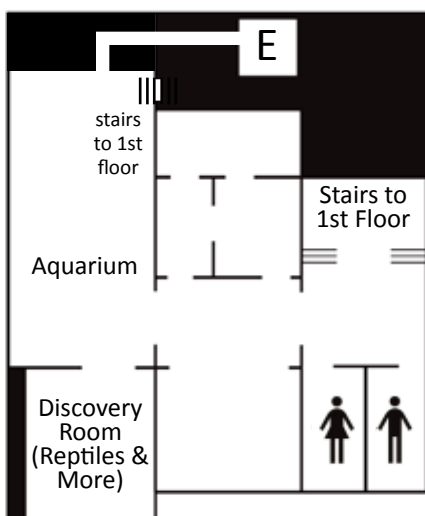

Ongoing Family Programs: Museum Adventures

Every Friday at 11 a.m.

Chow Time

Every Saturday at 12:30 p.m.

Art Lab

First Saturday of the month, 10:30 a.m.
RSVP requested, call 413.443.7171 ext 360

Kitchen Ka-Boom

Last Saturday of the month, 11 a.m.
RSVP requested, call 413.443.7171 ext 360